

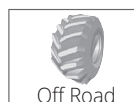

ENGINEERED FOR ADVENTURE



Built tough to follow your 4 wheel drive on great off road adventures, you'll have the confidence to get "there and back". Plus you'll do it in style with creature comforts you'd expect from Jurgens.







ROOF MOUNTED SOLAR



SLIDE OUT KITCHEN



FRONT STORAGE TRAY

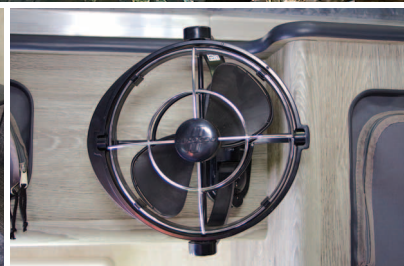

TWIN COOLING FANS

## THE JURGENS STORY

Our goal is to create the best caravans possible through intelligent design, genuine build quality and comprehensive testing.

We place emphasis on safe and efficient towing through engineering strength in where it is needed and taking weight out where it is not. Our products are light but not the lightest. We take into account building in all the features Australians expect and making a product tough enough for Australian conditions.

We appreciate function and understand how to optimise space for practical and comfortable living.

We have been developing caravans specifically for our market since 2008. Plus every Jurgens Caravan carries the DNA of 60 years international manufacturing experience.

We are part of one of the largest caravan manufacturers in the southern hemisphere. Jurgens have been manufacturing in South Africa since 1952 and have built over 100,000 caravans.

**60+** YEARS  
HERITAGE

**1** Year  
FACTORY  
WARRANTY



DINETTE CONVERTS TO A SINGLE BED

# FEATURES



EXTERIOR FEATURES	
Performance	
Optima chassis - galvanised. Engineered for maximum strength and minimum weight	Skid bars - front and rear to protect van in challenging terrain
Duratherm walls - composite construction for impact resistance, insulation and weight saving - 26mm aluminium outer skin for protection internal 20 mm high density foam for insulation with structural matrix for strength durable ply on both sides of foam core for strength internal lining - wash and wear	Special reinforcing brackets strengthen wall to floor connection to handle toughest conditions
	Cruisemaster® XT off road trailing arm independent suspension
	Twin Shock absorbers per wheel - 35mm gas charged for reduced operating temperatures
Chequer plate on walls for further protection	Single axle / 12" off road electric brakes
Front and rear panels - tough fibreglass construction	Stud pattern - suits Landcruiser 80 series 6 stud and Nissan Patrol (6 x 140 PCD, 1/2" studs)
Uniskin roof - fibreglass construction. Special profile design for greater strength and water drainage	Alloy rims (16" x 7J )
Roof soffit - one piece fibreglass	Off road tyres (245 -70R16)
Soffit surround - tough vinyl construction, dark colour to reduce light shine through, easy zip ventilation	Spare wheel - rear mounted
Pop top easy lift with internal lock down mechanisms	D035 coupler - for off road use
Integra Floor - one piece composite construction - maximum strength and minimum weight - 52mm aluminium outer skin for protection underneath internal 40mm high density foam for insulation with structural matrix for strength one piece ply on top and bottom of foam core for strength tough one piece vinyl covering on top	Jockey wheel - dual wheel for more surface area on soft surfaces
	Drop Jacks
Function	
A frame platform - handy for wood carrying	Double glazed windows for thermal and acoustic insulation
Slide out kitchen - with twin gas burner & hot / cold water sink	Stone protection blanket - covers front body
Utensil storage compartment	Large lockable easy access boot
Awning (roll out awning)	Gas bottles 9kg x 2
Shower (external) with hot and cold water	Side hatch access door storage compartment
Hand basin - external mount	Jerry cans 20 litre and rear mount holders x 2
Shower privy tent	240 volt power point - external
Shower floor mats - self draining	Annexe light LED 12 volt x 3 - Marker lights LED external
Water pump - 12v	Solar Panel
Hot water service - gas / electric - 22.7 litre capacity	Grab handles
Water tanks -100 litre main plus 60 litre reserve - durable polyethylene construction	Jack - hydraulic bottle type
Metal stone guards to protect water tanks	High lift jack point
Water tank filler / mains pressure inlet	Recovery tow points rear x 2
Mains pressure tap - external	
Plumbing and electrical lines shielded against stone damage	
INTERIOR FEATURES	
Comfort & liveability	Crockery set - plastic (6 person) - Crockery storage drawers
Double bed - 1900mm L x 1300 mm W	Portable entry step
Café Lounge converts to Single bed 1770mm L x 700mm W	
Fridge - compressor - 110 litre	Technical
Furniture - poplar ply, precision CNC router construction	Positive pressure hatch to reduce dust ingress - roof mounted
Storage compartments - zippable	USB connection and 12v socket
Vinyl floor - hard wearing	Lighting system 12 volt LED
Washable wall and furniture surfaces	Battery - (Not included in Tare weight)
Table portable for exterior use - with stowage compartment	Second battery box
Table for internal dining use (Converts to single bed)	Water tank level & battery indicator
Porta potti - with stowage compartment	Fire extinguisher & smoke alarm
Blinds / flyscreens on all windows and doors	Access compartment for plumbing maintenance



# TUFFTRAX LAYOUT

COMPACT COMFORTABLE OFF ROAD

XP1850

Sleep 3 - Double Bed / Café Lounge converts to Single Bed

Double Bed Dimensions - 1900mm L x 1300mm W

Single Bed Dimensions - 1770mm L x 700mm W

ATM	2000
Tare	1530
Payload	470
Towball Mass Tare	138

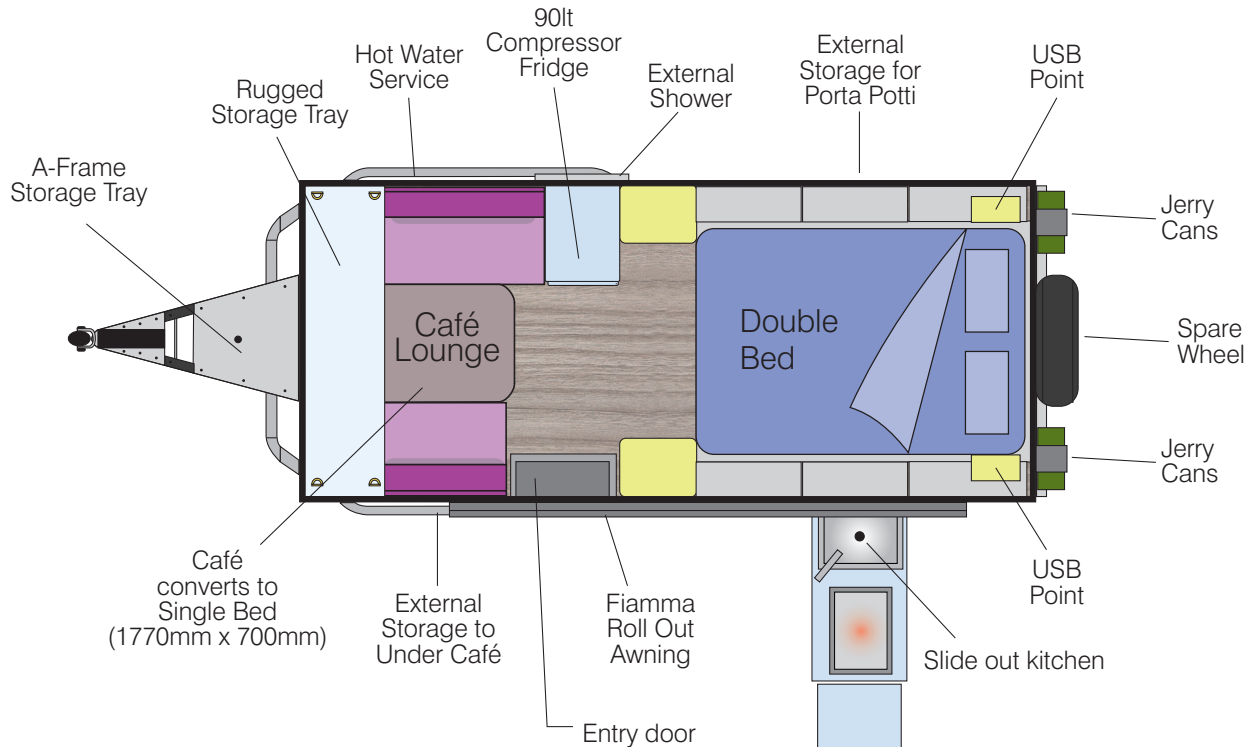

## TECHNICAL SPECIFICATIONS

	TuffTRAX	
	mm	ft
Body length - external mm / ft	4360	14'4"
Body length - internal mm / ft	4120	13'6"
Overall length - external mm / ft	5880	19'4"
Overall width mm / ft	2070	6'10"
Internal width mm / ft	1760	5'9"
Overall external height (roof raised inc. solar panel) mm / ft	2820	9'3"
Internal height (roof raised) mm / ft	1915	6'3"
Overall external travel height (roof down inc. solar panel) mm / ft	2395	7'10"
Interior travel height (roof down) mm / ft	1515	5'0"
Track width mm	1627	5'4"

Tough enough for great off road adventures

Your Authorised Jurgens Dealer:



Proudly built in Pakenham, Victoria, Australia

All dimensions are approximate. All weights have a +/- tolerance and vary depending on components added to or removed from van. Specifications and aesthetics subject to change without notice. Pictures are illustrative only and may show optional extras.

[www.jurgens.com.au](http://www.jurgens.com.au)